

Sandy Inox

Electrical submersible sludge pump 50HZ

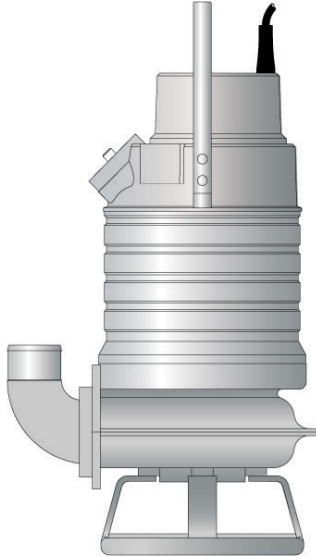

Pump specifications

Type	Sandy Inox
50Hz	Sandy Inox
Discharge connection	3"
Rated Power P} (kW)	6.3
Max. power consumption P{ (kW)	7.3
Shaft speed (r.p.m.)	2840
Rated current at 400V	12 A
Rated current at 500V	9.4 A
Solids passage (mm)	46
Height (mm)	755
Diameter (mm)	480
Weight (kg)	86

Other voltages on request

Features

General description

Submersible sludge pump made of stainless steel for mines, processing industries and salt-water applications

Classification

Electrical submersible pump. Protection Class: IP68

Electrical motor

Squirrel cage induction motor. Insulation Class: F (IEC85)

Motor protection

Phase sequence control, phase failure guard, temperature guard with thermal contacts in the stator (= SMART system).
Air valve

Cable - SubCab 20m (66ft)

50 Hz 380 - 500V: 4G2.5mm²

60 Hz 230: 4G4mm² -AWG12/4

60 Hz 460 - 575V: 4G2.5mm² - AWG14/4

Limitations

Max. submersion depth: 20m (66ft)

Max. liquid temperature: 40°C (104°F)

Allowed pH range: 2 - 10

Maximum liquid density: 1100kg/m³ (68lbs/ft³)

Shaft Seals

Double mechanical shaft seals running in an oil compartment

Material lower seal: silicon carbide - silicon carbide

Material upper seal: carbon - silicon carbide

Bearings

Ball bearings with C3 clearance

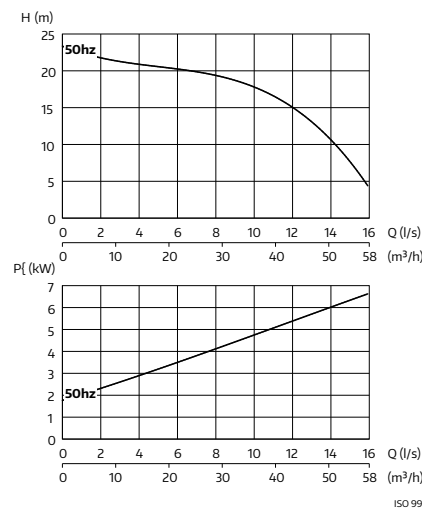

Discharge connection

3" hose, ISO-G BSP or NPT

Materials

Casted parts: Stainless steel (EN 10283-1.4412-ASTM CF-8M)

Outer casing: Stainless steel (EN 10088-3-1.4436-AISI 316L)

Motor shaft: Stainless steel (EN 10088-3-1.4460-AISI 329)

Impeller: Stainless steel (EN 10283-1.4412-ASTM CF-8M)

Screws and nuts: Stainless steel (A4)

O-rings: Viton rubber

Pump housing liner: Nitrile rubber

Accessories

Zinc anodes