

Smart Lite 400

Handy and Residue Pump 50 HZ



Pump specifications

OUTPUT	HEAD	FLOW
0.4kW	Rated : 7m	Rated : 2.3L/s
0.5HP	Max : 11m	Max : 4L/s
SHAFT SPEED		2850rpm
OUTLET		50mm
SOLID PASSAGE		7mm

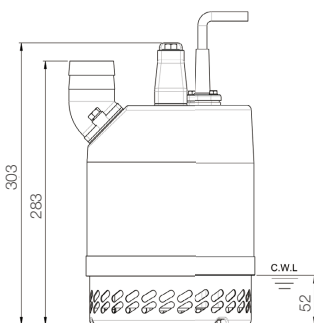
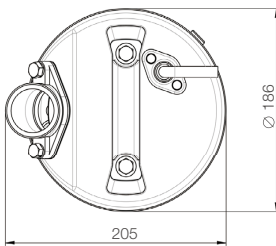
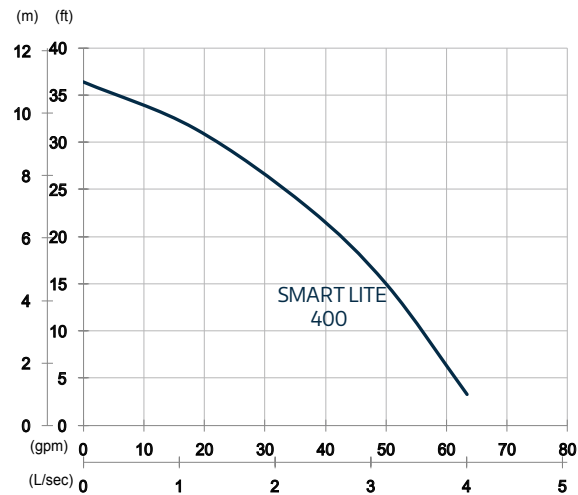

unit : mm
 Weight : 11kg

Features

Pump Type

Electric Submersible Pumps
 1-Phase

Motor

Type: Induction Motor
 Poles: 2 Pole
 Insulation: Class F
 Protector: Miniature Thermal Protector
 Starter: Capacitor-Run

Lubricant

Food Grade (ISO VG32)

Impeller Type

Semi-Vortex

Shaft Seal

Double Mechanical Seal
 Silicon Carbide VS Ceramic / Carbon

Bearings

C3 Shielded ball bearings

Cable

PVC (CSA Certified) / H07RN-F
 6m or longer upon request

Materials

Pump Casing: Gray Iron
 Impeller: Synthetic Polymers
 Motor Frame: Aluminum
 Motor Shaft: Stainless Steel
 Outer Case: Aluminum
 Strainer: Carbon Steel

Max. Liquid Temperature

40°C

Max. Submersion Depth

20m

pH Range

pH 5 - pH 8